

FLW-400

LDPE Root protection layer

ADVANTAGES

- Root protection
- Suitable for heavy use
- Large roll length → small transport cost
- Quick and easy installation
- Seamless, simply overlapping

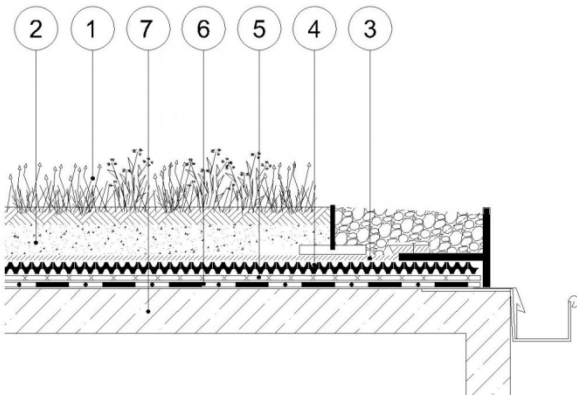

1. Vegetation, 2. Vegetation substrate SEM, 3. Geotextile filter VLF-150, 4. Drainage board DiaDrain-25H, 5. Mechanical protection fleede VLU-500, 6. Root protection layer **FLW-400**, 7. Building infrastructure

APPLICATION

Root protection membrane suitable for green roofs. Placed above the roof insulation as seamless, overlapping layers.

SPECIFICATION

Root resistant and vapour control layer type FLW-400 (DIADEM) ideal for extensive and semi-intensive green roof types, made of elastic polyethylene regenerate (PE-LD), seamless, with high tensile strength longitudinal > 15 Nmm⁻² and transverse > 16 Nmm⁻², tensile elasticity transverse > 350% and longitudinal > 450%, weight 370 g/m², thickness 0.4 mm, can be used as a root resistant layer on green roofs, protecting roof insulation infrastructure when laid down with a 1.0 m overlapping. Certified by FLL Root Proof Test and DIN 16938.



TECHNICAL DATA

Thickness (mm)	0.4
Width (m)	4.0
Length (m)	25
Weight (kg/m ²)	0.37
Density (g/cm ³)	0.923
Tensile strength MD (EN 12311-2)(N/50mm)	280
Tensile strength TD (EN 12311-2) (N/50mm)	260
Elongation MD(EN 527-1,-3): (%)	500
Elongation TD (EN 527-1,-3): (%)	600
Resistance to tear MD (N/mm)	40
Resistance to tear TD (N/mm)	70



Green Up the Roof!

