

# VLU-300

Protection layer

## ADVANTAGES

- Protection of building insulation and root protection membrane from mechanical stress
- High durability
- Easy to cut

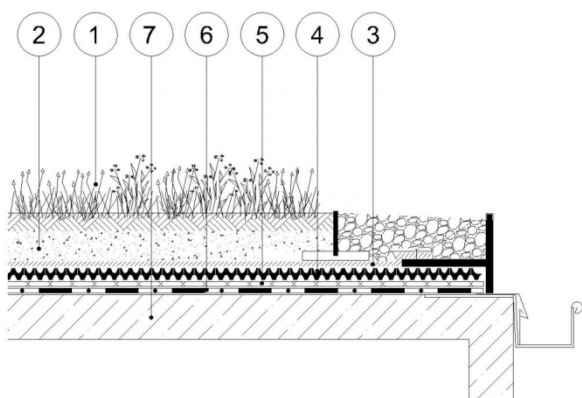

1. Vegetation, 2. Vegetation substrate SEM, 3. Geotextile filter VLF-150, 4. Drainage board DiaDrain-25H, 5. Protection layer **VLU-300**, 6. Root protection layer FLW-400, 7. Roof construction

## SPECIFICATION

Synthetic layer of high-quality recycled synthetic polypropylene fibers, of high mechanical strength, heat resistant, thickness 1.8 mm, weight 300 g/m<sup>2</sup>, tensile strength 2.7 kN/m in longitudinal direction and 3.7 kN/m in cross direction, biologically and chemically neutral, resistant to bacteria and microorganisms, fertilizers and organic compounds e.g. pesticides, root excretions etc. The material complies with FLL specifications and its durability complies with international and national standards (EN ISO 12956, EN ISO 10319, EN ISO 11058, EN ISO 12236, EN ISO 13433 MSZ 93-9:1985, EN 13252).



## TECHNICAL DATA

Thickness (mm)	1.8
Width (m)	2.0
Length (m)	50
Weight (g/m <sup>2</sup> )	300
GRK	2
Density (g/cm <sup>3</sup> )	0.9-1.38
Tensile strength in longitudinal direction (KN/m)	2.7
Tensile strength in cross direction (KN/m)	3.7
CBR-test (N)	1000



Green Up the Roof!

