

TRF/TRH/TRS/TRK

Terrace grids

ADVANTAGES

TRF - terrace grid

- Can be installed on terraces paved with concrete slabs
- The dense grid space guarantees safe walkway and protects the outlet from pollutions
- Simple installation

TRH - terrace grid with adjustable height

- The polypropylene body decreases the heat stress of the underlay layers, and prevents thermal bridging
- Fits most local height features
- Fits every type of terrace outlet

TRS - doorstep grille

- Can be installed in front of open or closed-bottom door-posts
- Easy to clean
- The polypropylene body decreases the heat stress of the underlay layers, and prevents thermal bridging
- Ensures the fast drainage of surface water on roof terraces.

TRK - gravel basket and gravel basket extension

- Height of the gravel basket can be increased with 20 cm using the extension
- Keeps away the growing media from the outlet In case of a high layer structure



SPECIFICATION

TRF

Step-resistant terrace grid for quick conducting of the surface water on roof terraces, with plastic bottom part and dip galvanized steel mesh grid. Grid opening: 30x10mm; loading class: A15; material of bottom part: polypropylene; material of grid: dip galvanized steel; mise: 30 x 30 x 5 cm (LxWxH); mass: 2,3 g/pc.

TRH

Adjustable height (m=8 - 11,5 cm), step-resistant terrace grid for quick leading of surface water on roof terraces, bottom part in plastic and dip galvanized mesh grid. Grid opening: 30x10 mm; loading class: A15; material of bottom part: polypropylene; material of grid: dip galvanized steel; size: 30 x 30 x 8-11,5 cm (LxWxM); mass: 2,67 kg/pc.

TRS

Doorstep-grille with galvanized mesh grating installable in front of open or closed-bottom door-posts for quick water drainage. Grid opening: 40x10 mm; loading class: A15; material of bottom part: polypropylene; material of grid: dip galvanized steel; available size: 100, 75, 60cm (L) and 50, 50, 40cm (W) and 5cm (H); weight 10,35 kg/pc.



ΠΡΑΣΙΝΗ ΣΤΕΓΗ
Κ.Π. 2002 - ΑΦΗΜΕΤΑΛΟΓΙΣΜΟΣ

Green Up the Roof!

DIADEM®

TRF/TRH/TRS/TRK

Terrace grids

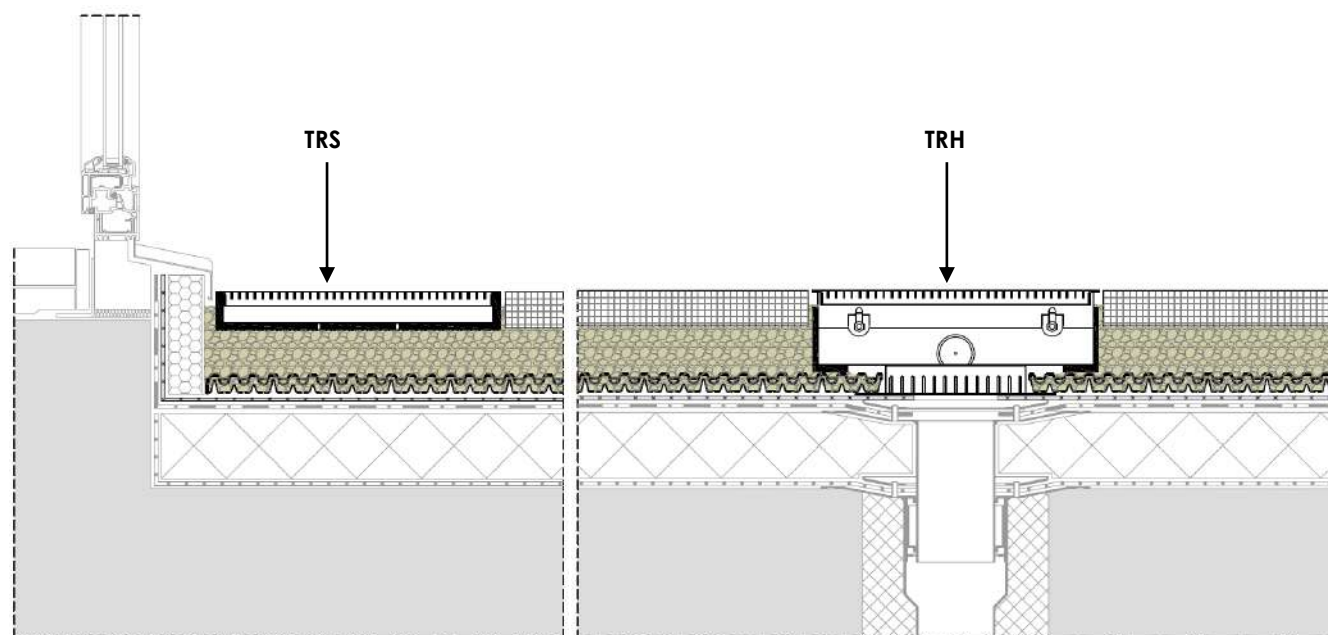

PRODUCT	LxWxH (cm)	WEIGHT (kg)	MESH SIZE (mm)	DRAINAGE OPENING	MATERIAL (BASE)	MATERIAL (GRID)
TRF-FF-40-FF	40x40x4	4,6	30x10	-	-	
TRF-FF-50-FF	50x50x4	6,16	30x10	-	-	
TRF-30-FF-MW-30/10	30x30x5	2,3	30x10	-	-	
TRF-40-FF-MW-30/10	40x40x5	3,79	30x10	-	-	Dip galvanized steel
TRF-50-FF-MW-30/10	50x50x5	5,24	30x10	-	-	
TRH-30-FF-MW-30/10	30x30x8-11,5	2,67	30x10	4 units, D52 mm	polypropylene	dip galvanized steel
TRH-40-FF-MW-30/10	40x40x8-11,5	4,23	30x10			(standard) or stainless steel (custom)
TRH-50-FF-MW-30/10	50x50x8-11,5	6,4	30x10			
TRS-60-FF	60x40x5	6,67	40x10	4 units, D52 mm	polypropylene	dip galvanized steel
TRS-75-FF	75x50x5	10,35	40x10			(standard) or stainless steel (custom)
TRS-100-FF	100x50x5	13,15	40x10			
TRK-20-AL	20x20x4	0,14	-	-	-	aluminium
TRK+AL	20,3x20,3x20	0,3	-	-	-	