

KSE

Drain inspection box

ADVANTAGES

- For central drains
- Protects drains from pollutions
- Direct access for inspection and maintenance
- Lockable cover plate
- Polypropylene material to prevent thermal bridging
- Available at various heights

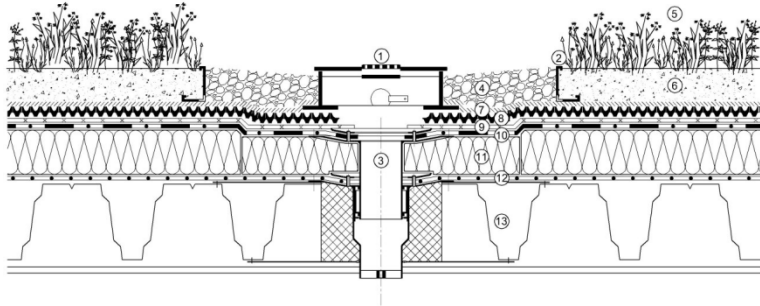

1. Inspection box **KSE-10**, 2. Metal edging KLS AL 8/12, 3. Drain, 4. Pebble material, 5. Vegetation, 6. Vegetation substrate SEM, 7. Geotextile filter VLF-150, 8. Drainage board Diadrain-25H, 9. Protection fleece VLU-500, 10. Root protection layer FLW-400, 11. Existing insulation, 12. Existing waterproofing, 13. Roof construction

APPLICATION

KSE inspection boxes are placed in central drains (not parapet).

They protect the drain from pollutants and ensure direct access for inspection of drainage. Available at various heights for all types of green roofs, while height can be adjusted with the help of 10cm high extension elements.

SPECIFICATION

Inspection box for green roof parapet drainage system at 10, 15, 20, 30 cm. Dimensions 30x30 cm, high quality polypropylene for prevention of thermal bridging, with opening at the back, lightweight, lockable lid and galvanized steel perforated cover for ventilation (diameter 120 mm), RAL 7032.



TECHNICAL DATA

Height (cm)	10, 15, 20, 30
Width (cm)	30
Length (cm)	30
Weight (kg/unit)	1.49 / 2.19 / 3.47 / 4.85
Surface drainage opening (mm)	120
Material	Polypropylene
Drainage tube connection	4, $\varnothing=52$ mm
Lock	Available
Extension element height (cm)	5/10
Colour	RAL 7032



Green Up the Roof!

