

# KSA

Drain inspection box

## ADVANTAGES

- For parapet drainage
- Protects drains from pollutions
- Direct access for inspection and maintenance
- Lockable cover plate
- Polypropylene material to prevent thermal bridging,
- Available at various heights

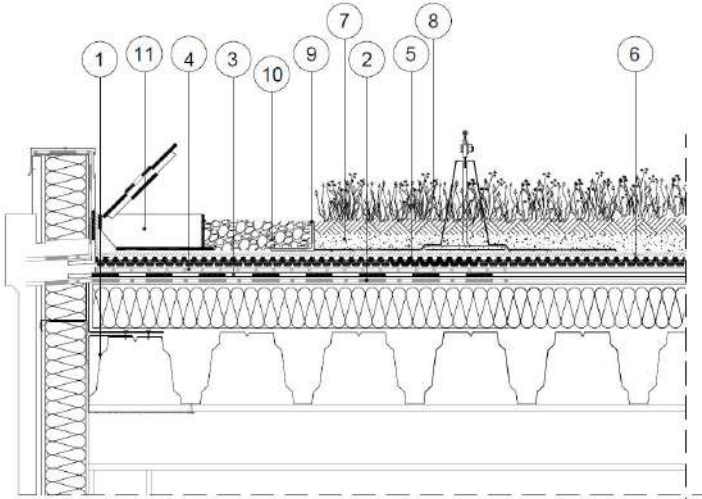

1. Roof construction, 2. Insulation, 3. Root protection FLW-400, 4. Mechanical protection fleece VLU-300, 5. Drainage board Diadrain-25H, 6. Geotextile filter VLF-150, 7. Vegetation substrate SEM, 8. Vegetation, 9. Edging element KLS AL 8/12, 10. River pebble material, 11. Inspection box **KSA-10**, 12. Safety system

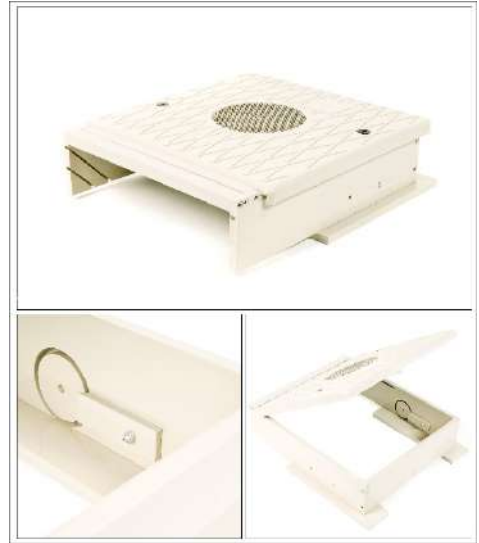

## APPLICATION

KSA inspection boxes are placed on parapet drainage systems.

They protect the drain from pollutants and ensure direct access for inspection of drainage. Available at various heights for all types of green roof.

## SPECIFICATION

Inspection box for green roof parapet drainage system at 10, 15, 20, 30, 40, 50 cm. Dimensions 30x35 cm, high quality polypropylene to prevent thermal bridging, with opening at the back, lightweight, lockable lid and galvanized steel perforated cover for ventilation (diameter 120 mm), RAL 7032.



## TECHNICAL DATA

Height (cm)	10, 15, 20, 30, 40, 50
Width (cm)	30
Length (cm)	35
Weight (kg/unit)	1.65/2.25/3.85/4.45
Surface drainage opening (mm)	120
Material	Polypropylene
Drainage tube connection	3, $\varnothing=52$ mm
Lock	Available
Colour	RAL 7032

