

DiaSafe® Wall-Fix

Fall Protection Anchoring System

130905
130906
130907



ADVANTAGES

- Can be combined with DiaSafe® ballasted systems
- Hands-free → unhindered movement along the safety line
- 3 types of system are available – Single Duo, Line Multi, Glide Duo
- Stainless steel

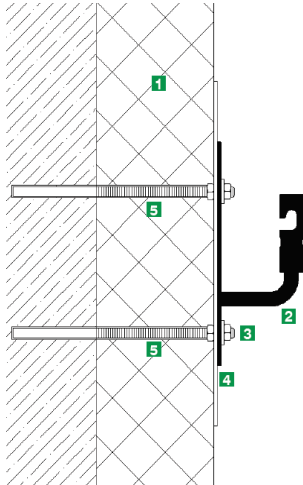

DIADEM® BUILD-UP

1. Thermal insulation
2. DiaSafe® Wall-Fix
3. fastener
4. washer
5. Spacer tube* in case the wall is insulated for load distribution

SINGLE DUO - 130905 LINE MULTI - 130906 GLIDE DUO - 130907



Can be used by 1 or 2 persons.



One person can be attached to every second section Simultaneously.



Can be used by 1 or 2. System allows unhindered movement through heads of anchoring posts.

APPLICATION

Made to be mechanically fixed to wall structures with adequate load bearing capacity for securing people working at heights.



100% recyclable



SPECIFICATION

CE-marked safety system against falls from height, fixed mechanically to building structure with adequate load bearing capacity according to the standards EN 795:2012 and CEN/TS 16415, class A and C certified as fall arrest or fall restraint system. With system components made of stainless steel.

TECHNICAL DATA

Maximum inclination of roof	45°
Maximum number of users	2
Wall anchors minimum distance	1.5 m
Wall anchors maximum distance	8 m
Tensile strength of cable [kN]	33,4 KN
Maximum static load of the system during a rescue process according to EN795:2012	600 kg
Material	1.4404 (316) stainless steel



ΠΡΑΣΙΝΗ ΣΤΕΓΗ
ΕΠΙΧΕΙΡΗΣΙΑΚΗ ΑΝΩΝΥΜΗ ΕΤΑΙΡΕΙΑ

Green Up the Roof!

